

Electronic instantaneous water heater DCX (since 08/2012)

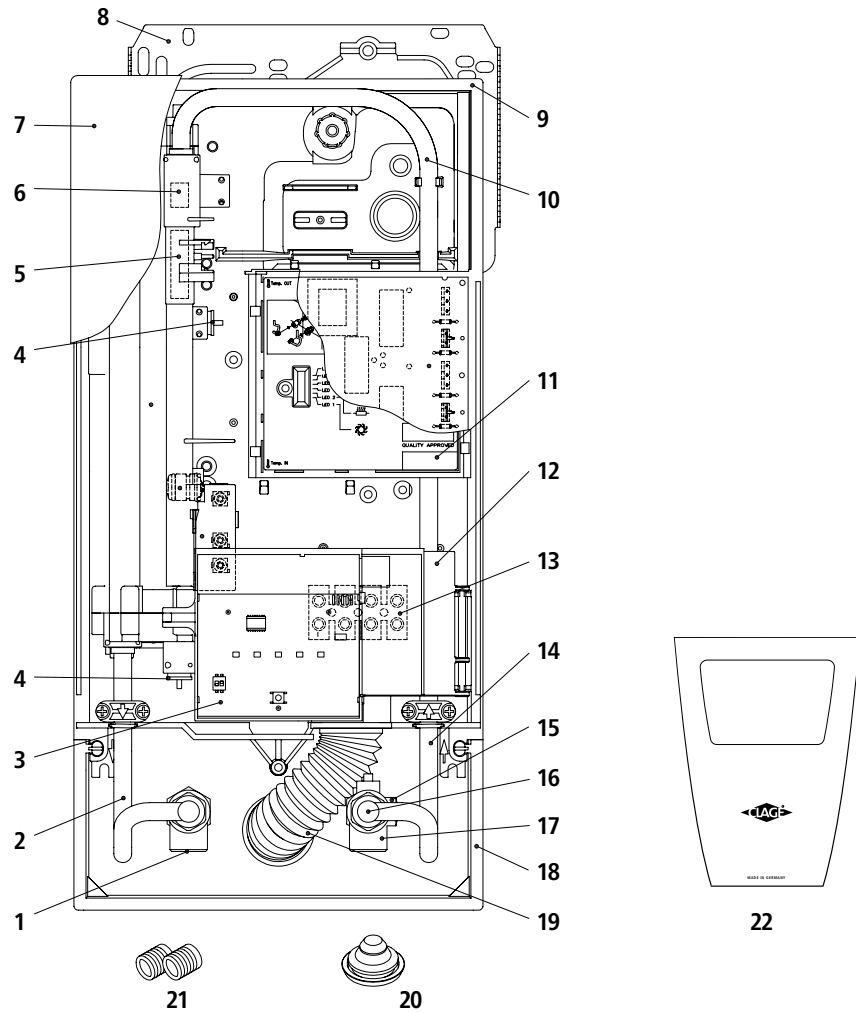

Pos.	Art.-No.	Description	Euro*	Pos.	Art.-No.	Description	Euro*
1	82085	Hot water connection	25.00	14	82531	Inlet pipe	15.00
2	82529	Outlet pipe	12.00	15	82162	Fine filter	5.00
3	82553	DCX control panel	65.00	16	89110	Flow limiter 8 l/min	3.00
4	82851	DCX thermal sensor set 2.1	32.00	17	82074	Cold water connection	25.00
5	82526	Flow sensor	14.00	18	82571	Frame	6.00
6	82246	Non-return valve	6.00	19	82060	Water splash protection sleeve	5.00
7	82508	DCX hood	25.00	20	82180	Grommet	4.00
8	82520	Wall bracket	5.00	21	82110	Screw-in nipples 1/2"	4.00
9	82505	Bottom part	15.00	22	82504	Faceplate	7.00
10	82591	DCX connecting pipe	10.00	Not shown:			
11	82852	PCB cover 2.1	5.00	23	82598	Set of small spare parts	10.00
12	82573	Control panel support	5.00	Parts in bold type are key components for servicing purposes.			
13	82572	Connecting terminal	4.00				

When ordering, please always specify the appliance model and serial number from the rating plate. Further spare parts on request. Please contact our customer service if you have a defect heating element or electronic board.

CLAGE GmbH
 Pirolweg 1–5, 21337 Lüneburg
 Fon: +49(0)4131·8901-0
 Fax: +49(0)4131·83 200
 E-mail: export@clage.de

Service:
 Fon: +49(0)4131·8901-40
 Fax: +49(0)4131·8901-41
 E-mail: service@clage.de
 Internet: www.clage.de